

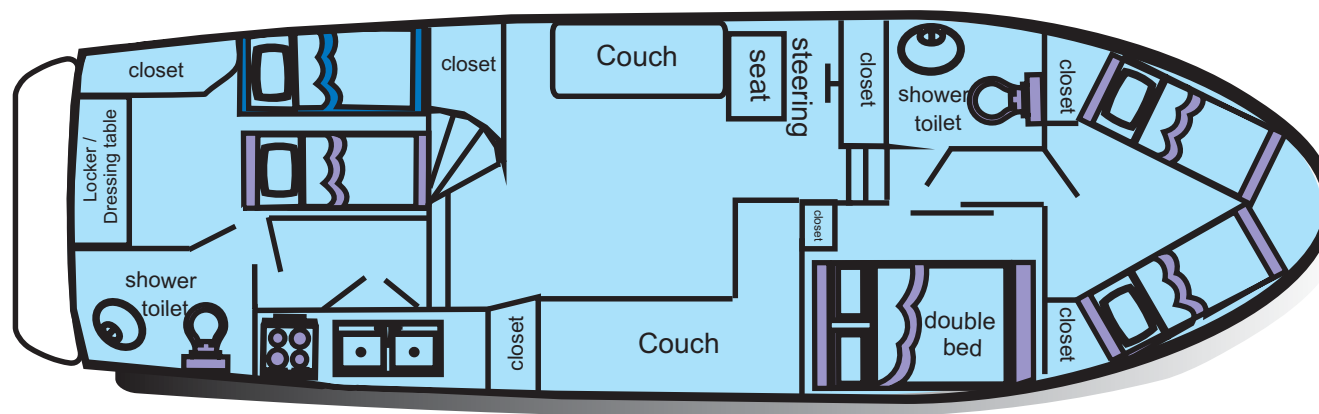

Wavequeen

6-8-berth, ideal for three couples or a family

4 seperate cabins, 2 toilets with sink and shower,
large galley with 4-ring hob and oven (gas) & fridge (12V),
radio/CD/MP3, 12-V-cigarette lighter sockets,
220V inverter, hot water supply,
hot air heating, 2nd steering outside (flybridge), sun deck,
Built: 1998/99



Specifications

Length:	11,30m
Beam:	3,65m
Draft:	0,90m
Airdraft:	2.80m
Engine:	Perkins M90
Gearbox:	Borg-Warner
Diesel:	approx 225 ltrs
Water:	approx 360 ltrs
Waste water:	approx 270 ltrs

€99.500

inc @ VAT 23%